

PRESCRIBED COMPOSITE MAP No. 257

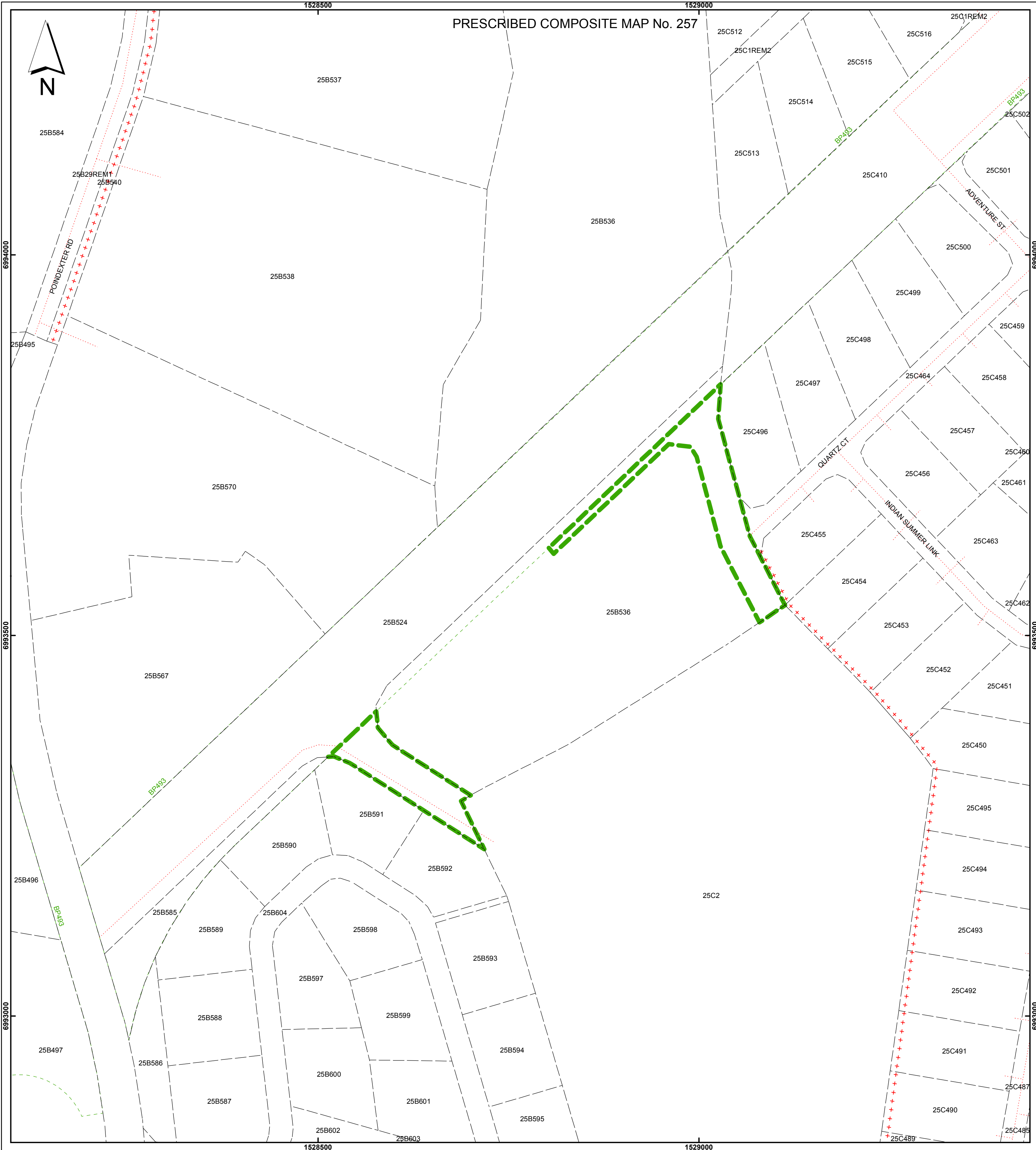

Prepared by : Date :	J. Dixon 22 Feb. 2010
GIS checked by : Date :	J. Dixon 6 April 2010
Quality Control by : Date :	
Chief Surveyor : Date Approved :	R. Vasquez 8th April 2010
L&S Job No. : Forms: PCM_Small	25277

TITLE	ROAD DEFINITION OF ROAD OFF EAST WEST ARTERIAL, PROSPECT	
	SCALE	
LEGEND / ABBREVIATIONS / AMENDMENTS		
Road Definition		Gazette 13/2011, Monday 20 June 2011 Base Plan: 03/346

PRESCRIBED COMPOSITE MAP No.	257
BLOCK No.	25B
LANDS AND SURVEY DEPARTMENT CAYMAN ISLANDS GOVERNMENT P.O. Box 1089 Grand Cayman KY1-1102 CAYMAN ISLANDS	